

Rotary Tillers

RTA12 Series

Model	RTA1242	RTA1250	RTA1258	RTA1266	RTA1274
Recommended Tractor PTO HP	15 to 35 HP		20-40 HP		25-50 HP
Weight	362 lbs	389 lbs.	419 lbs.	448 lbs.	480 lbs.
Tilling Width	42"	50"	58"	66"	74"
Overall Width	47 3/8"	55 3/8"	63 3/8"	71 3/8"	79 3/8"
3-Point Hitch Type	Category I, Adjustable Lower Hitch Clevis with Plated Pins Fits Land Pride Quick Hitch				
Sideshift Capabilities	Yes, Cannot offset with Quick-Hitch				
Sideshift Dimensions	Centered	Centered	Centered	Centered	Centered
Shifted Right	16" - 26"	25" - 25"	29" - 29"	33" - 33"	37" - 37"
Shifted Left	13" - 29"	18" - 32"	22" - 36"	26" - 40"	30" - 44"
Number of Flanges on Rotor	5	6	7	8	9
Number of Tines per Flange	4				
Tine Construction	Alloy steel heat treated "C" shaped blades				
Rotor Rotation	Forward Rotation				
Rotor Swing Diameter	15"				
Rotor Shaft Speed	211 rpm at 540 rpm PTO				
Rotor Bearing Mounts	Machined cast iron				
Skid Shoes	Adjustable				
Storage Stands	Adjustable				
Rear Deflector	Adjustable profile stamped rear deflector				
Front Deflector	None (Not required with RTA forward rotation)				
Driveline	Category II with Slip Clutch				
Gearbox	Construction	50 HP input at 540rpm 1.92:1 ratio, Cast iron housing with ASAE 1 3/8" - 6 spline shaft, tapered roller bearings, bevel gears, drain plug, level plug & fill plug			
	Lubrication	SAE 80-90W EP oil			
	Capacity	2 pints			
Drive Chain	#80 Roller chain - Fully enclosed in oil bath with drain & fill plugs				
Drive Chain Lubrication	Shell Alvania EP 00 or equivalent				
Sprockets	Case hardened teeth, splined bores				

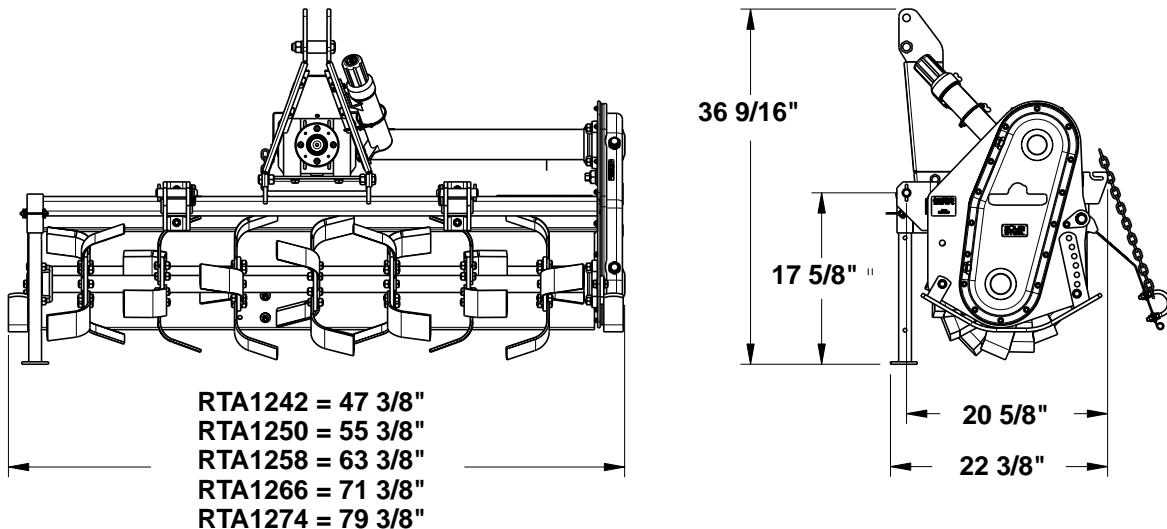

Designs, specifications, teatures and information are subject to change without notice.

30365

Rotary Tillers

RTR12 Series

Model	RTR1242	RTR1250	RTR1258	RTR1266	RTR1274	
Recommended Tractor PTO HP	15 to 35 HP		20 to 40 HP		25 to 50 HP	
Weight	405 lbs.	434 lbs.	478 lbs.	497 lbs.	529 lbs.	
Tilling Width	42"	50"	58"	66"	74"	
Overall Width	48 1/4"	56 1/4"	64 1/4"	72 1/4"	80 1/4"	
3-Point Hitch Type	Category I, Adjustable Lower Hitch Clevis with Plated Pins Fits Land Pride Quick-Hitch					
Offset Capabilities	Yes, Cannot offset with Quick-Hitch					
Sideshift Dimensions	Centered	16" - 26"	25" - 25"	29" - 29"	33" - 33"	37" - 37"
	Shifted Right	16" - 26"	18" - 32"	22" - 36"	26" - 40"	30" - 44"
	Shifted Left	23" - 19"	32" - 18"	36" - 22"	40" - 26"	44" - 30"
Number of Flanges on Rotor	5	6	7	8	9	
Number of Tines per Flange	4					
Tine Construction	Alloy steel heat treated "C" shaped blades					
Rotor Rotation	Reverse Rotation					
Rotor Swing Diameter	15"					
Rotor Shaft Speed	211 rpm at 540 rpm PTO					
Rotor Bearing Mounts	Machined cast iron					
Skid Shoes	Adjustable					
Storage Stands	Adjustable					
Rear Deflector	Adjustable profile stamped rear deflector					
Front Deflector	Rubber					
Driveline	Category II with Slip Clutch					
Gearbox	Construction	50 HP input at 540rpm 1.92:1 ratio, Cast iron housing with ASAE 1 3/8" - 6 spline shaft, tapered roller bearings, bevel gears, drain plug, level plug & fill plug				
	Lubrication	SAE 80-90W EP oil				
	Capacity	2 pints				
Drive Chain	#80 Roller chain - Fully enclosed in oil bath with drain & fill plugs					
Drive Chain Lubrication	Shell Alvania EP 00 or equivalent					
Sprockets	Case hardened teeth, splined bores					

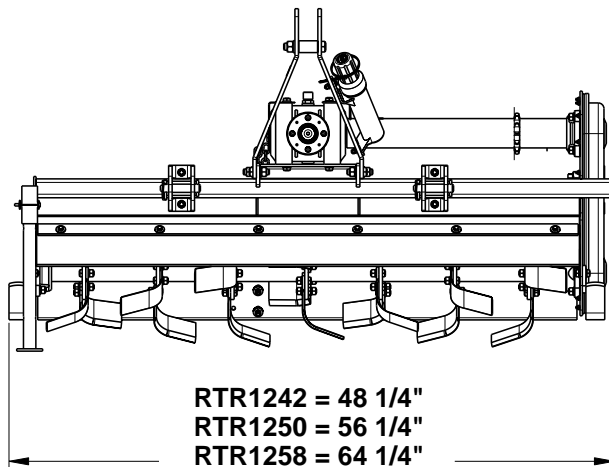

RTR1242 = 48 1/4"
 RTR1250 = 56 1/4"
 RTR1258 = 64 1/4"
 RTR1266 = 72 1/4"
 RTR1274 = 80 1/4"

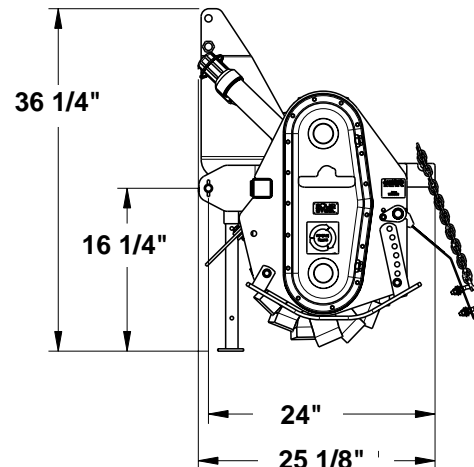

Designs, specifications, features and information are subject to change without notice.

30359